

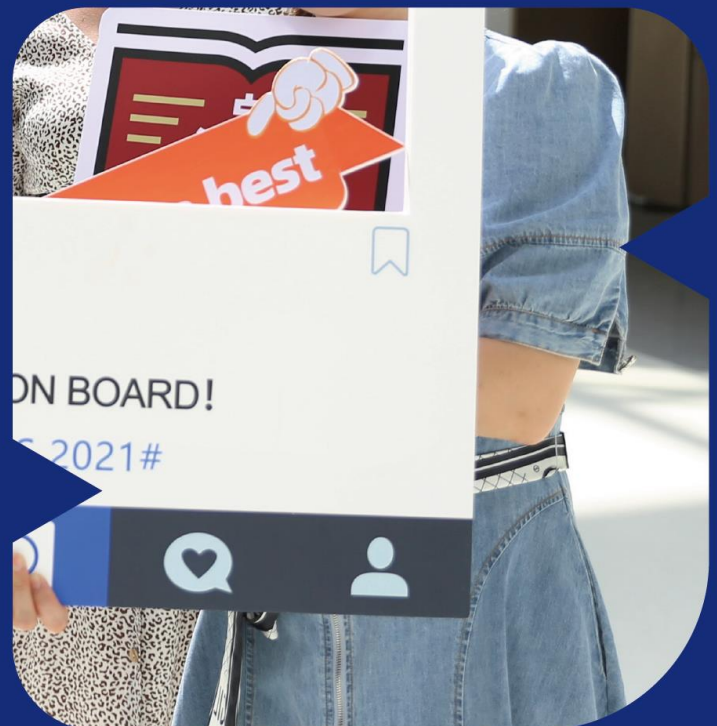

Ningbo British
International
School



Cambridge Assessment
International Education

Cambridge International School



Address: No. 365 Guanghua Road, National Hi-Tech Zone, Ningbo 315000

Website: www.nbis.net.cn

Tel: 86 574 87611005

Email: nbis.admin@nbis.net.cn

Fax: 86 574 87611136

2021-2022

NBIS WEEKLY NEWSLETTER

BACK TO SCHOOL!

The long summer holiday is over. And now it's time for school!

We were delighted to welcome many parents and students to Orientation Days this week. We are excited to be working in such a lovely environment and truly grateful to the many who have worked so hard so that we can open on time with confidence.

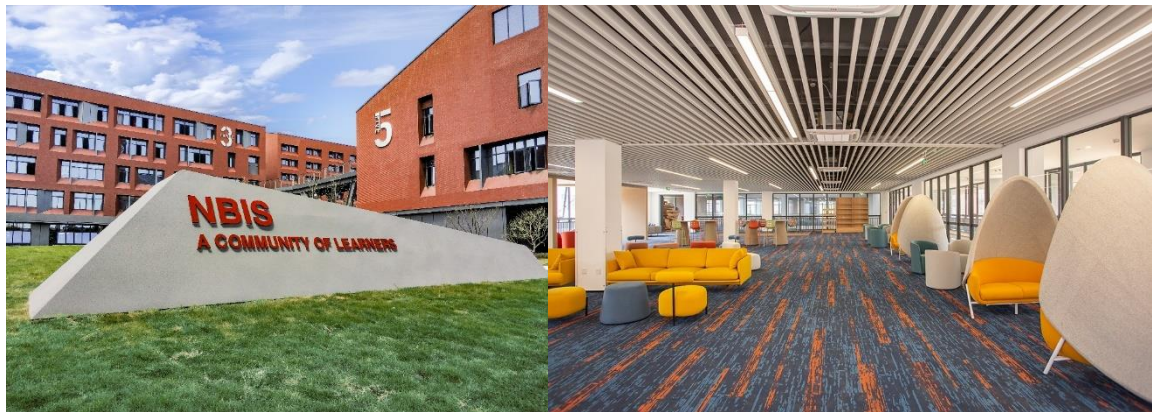

Ningbo British
International
School

A COMMUNITY OF LEARNERS

Please find here important, practical information:

Student Access to the Campus:



School Buses will enter through the bus gate and proceed to the appointed drop-off. Students will be greeted and directed by the Bus Supervisor and Duty Team.

Pedestrians and cyclists enter by the main gate on Guanghua Lu. Cyclists must dismount to enter and following the orange pathway, park their bicycles in the designated area behind Building 1.

Students on e-bikes must enter and exit by the bus gate, and park in the designated area behind Building 1.

Parents or drivers should drop students off and pick them up by the main gate in Guanghua Lu. To be safer, drop them on the school side so that they do not have to cross the busy road. Please do not park or wait long, and do not block the gates. It is likely to be busy and a little chaotic until we all get used to the arrangements. Please be patient and courteous and most important: safe.

With regret, according to regulations for schools, parents are not allowed on campus. (Of course, individual parents are welcome to make appointments for specific business or concerns.)



School Buses:

The school has issued bus information to families using buses. We have 8 School Buses and have assigned the optimal routes and stops for them in line with traffic regulations and advice from our experienced drivers. Especially during the first few days, the times of pick-up and drop-off may vary. Bus Teachers will be in touch with parents if there are any significant delays. Please be patient as we settle into the new routine. All students riding buses must follow the instructions of the Bus Teacher and abide by NBIS School Bus Policy.

- The Bus Administrator is Ms Vicky. Responsible for all logistics.
- The Bus Supervisor is Ms Paulette. Responsible for Bus Policy, arrival and departure arrangements.
- Each bus has an assigned Bus Teacher responsible for daily safety and communication with parents and school.

Uniform:

Students should attend school in uniform. School does not prescribe which uniform items must be worn except when we have a formal event, and parents will be given advance notice of that. Students may choose to wear a polo, or shirt, shorts or trousers. There is some flexibility. All tops have the NBIS Logo.



In collaboration with the uniform company and parents, we will establish a deadline for correct uniform and inform parents.

Student attendance and temperature will be recorded daily by the teacher.



2021-2022

NBIS WEEKLY NEWSLETTER

Food Security:

It is essential that we take great care about food on campus. The school kitchens, quality of food and food services provided by the school are regularly inspected by government officials. We implement the highest possible level of practice and – should there be any problem – we are able to quickly and clearly track the source.

Students with religious or medical dietary constraints or preferences are welcome to bring lunch from home. Microwave ovens are available to heat food.

However, students bringing lunch from home will sit in a designated area of the Dining Hall, not with those who are eating school food. This is to avoid the sharing of food from different sources and the protection of food security. The school can only be responsible for the food it provides; not for the food provided from outside sources. At first, this will seem a little strange to students with home lunches; but it will give opportunity for students to make new friendships over lunch.



Ningbo British
International
School

A COMMUNITY OF LEARNERS

PE (Physical Education):

We are not able to use the new PE facilities yet. The PE Teachers will inform students about the contingency arrangements (location and activity). We will open the PE facility as soon as it is safe to do so. The track and field are available to us – which is great as the fine autumn weather approaches, and we have other spaces ... such as our Dance Studio ... in which activities can take place.

Auditorium:

Technicians are still at work in the Auditorium, especially in the control room for light and sound. We hope to be able to use it soon! And yes ... it will be tested for air quality again and confirmed safe before we open it.

Lifts/Elevators:



The new school campus has many lifts. Students in Early Years, Primary and Secondary Y7-11 are permitted to use the lifts only when accompanied by a teacher for a specific activity. This is for safety and to promote a healthy lifestyle. Senior Students in Y12+13 may use the lifts as a Senior Privilege.

Of course, students with a medical certificate can use the lifts!

Troubleshooting:

No doubt during the first couple of weeks of school, we will encounter some challenges. This would be the case with any new building of this size. We have a team from the construction company on site to address any issues that arise. And of course, safety is always at the top of the list.



Communication:

General:

- Early Years – WeChat groups administered by Teachers
- Primary – Class dojo administered by Teachers
- Secondary – Email to Teacher

Communication between teachers and parents is important. We value parent feedback and ideas.

The principle for communicating about specific educational concerns for your child/ren is that we seek to solve problems at the lowest possible level with the least disruption. Most problems are solved by addressing them directly to the teacher concerned.

1. Contact the Class/Homeroom or Subject Teacher
2. If you need further help, contact the Head of Section
3. If your issue has not been resolved, contact the Principal

Emergency Evacuation

All Teachers have been briefed about Emergency Evacuation and various Assembly Points have been designated. We are ready to evacuate safely in case of emergency.

A Moment in Time

Since 2005, it has been a dream that NBIS should have its own independent campus. That dream is now a reality and the teachers and students of 2021-22 have the privilege of being the first to live, work and study here.

It is my hope that we can all grasp this moment and move forward positively to put NBIS on the map not only in Ningbo, but also in Zhejiang Province and beyond.

As we begin the new academic year together let's imagine a better future.

NBIS: IMAGINE A BETTER FUTURE



2021-2022 Early Years Welcome

We hope you have all had a lovely relaxing summer holiday break. We are very excited for the 2021/2022 year to begin. We would like to welcome back our returning Early Years children and their families, and also offer a warm welcome to our new children and their families who will be joining us this year at NBIS. Our Early Years team have been busy setting up the classrooms at our fabulous new campus, and are all looking forward to the children arriving on Monday morning, and supporting them as they settle into their respective classrooms. On the first day it would be helpful if each Early Years child could bring.

- a blue bucket hat (these can be purchased from the school office for 15RMB).
- a drinking cup for the children to use during snack times for milk and yoghurt.
- a full water bottle. We will refill these as needed during the day.
- A spare NBIS uniform and underwear that will be kept at school
- Bedding for rest/sleep time. New children's bedding, if already purchased, will be supplied to them on the first day. If bedding is still to be purchased the cost of 300RMB can be paid to either the class teacher or Vicky. All children in Early Years require **school bedding**.

Can you please make sure that all of these items are named.

It is common at the beginning of the year, even for returning children, to be a little anxious. Please prepare your child, and yourself, for a smooth first day back by explaining what to expect. If you are delivering your child to school, please make your morning goodbye short and sweet with a hug, kiss and a promise to be back, or let your child know that you will see them at home after school. Trust in the teachers to settle your children from here. We will contact you if needed.



2021-2022

NBIS WEEKLY NEWSLETTER

On the first day of school (and all other school days), Early Years children will be taken directly to their classroom. There will be Early Years staff members at the NBIS main entry gate to greet and collect them, and take them to their classrooms between 8:40am and 9:00am. If you are running late and arrive after 9:00am you will need to contact your child's classroom Teacher and they will organize someone to come and collect your child from the NBIS main entry gate. Please do not send Early Years children through the campus entry gate unattended. They need to have someone meet them and help them find their way to their classroom. For Early Years children who will be catching the School Bus to school, Bus Teachers will deliver them directly to their classroom each day, and at the end of the school day class Teachers will deliver them to the Bus Teacher.

Thank you,

The Early Years Team



Ningbo British
International
School

A COMMUNITY OF LEARNERS



Primary Welcome

A warm welcome to all the students and parents of the primary section. We trust that you had time to relax over the summer break and are as excited as we are about the return to school. There is so much to look forward to as we embark on our learning journey together in our brand-new campus. The Primary Teaching Team is full of enthusiasm and excitement for the opportunities and challenges that lie ahead. It is our mission to provide a first class educational, personal and social experience for each and every student, providing the opportunity for every student develop and be the very best that they can be!

It is a real pleasure to welcome a number of new families to the NBIS family this year. We also have new members of staff, who bring with them a range of experiences and expertise to enrich our school community. You will have an opportunity to meet with your child's teacher and find out more about teaching and learning at our Curriculum Meetings early in September.

In the Primary Section, we understand the importance of communication between home and school to ensure the best educational experience for every child. The close relationships between home and school enables us to work together to ensure that every child is given the opportunity to achieve their potential. Once again, we will be using Class Dojo as our means of communication with parents. Through Class Dojo we can provide Primary Section information, individual class updates, celebrate success and the ability to contact class teachers individually.

We are looking forward to an exciting year filled with learning, enthusiasm, laughter and friendship. We wish you all the very best for the year ahead.

Sonya Potts
Head of Primary



Secondary Welcome

The Secondary Section has a different look as we open the new school year ... and it's not just the fantastic building ...

It is the fastest-growing Section in school with around 20 new students and a total of over 150.

To support the growth of the Section, we have split Y7-9, so that now we have two classes in each year group ... Y7A, Y7B and so on.

We have 8 new teachers in the department, all keen to engage with students, challenge and support them with new learning and understanding.

And we will have our most varied ECA programme once we have settled and established routines on the campus.

I'm delighted that we've been able to introduce Music into the curriculum for Y7-9 with the addition of Zhourong Lyu (known as Kaia) for Piano and Performance, and Isidro Santos Galindo for Cambridge Music and wind instruments. It is our aim over the next few years to establish a robust Music Department and to have the wonderful sound of music in our school!

We look forward to welcoming students on Monday. NBIS is their school and, like many before them, we hope they will make it a place of curiosity and creativity, fun and challenge, hard work and productivity.

We are working together for a better future!

Philip R Billing

Acting Head of Secondary



Good News from Secondary

NBIS is now an accredited SAT Centre! The Scholastic Aptitude Test is designed to examine the readiness of students to progress to college in the USA, and SAT scores are important for university admission. Other countries, such as Korea, are familiar with this test and will take account of the score for students wishing to enrol in Korean universities.

NBIS students will now be able to take the test at NBIS rather than travelling to other centres (usually in Hong Kong or Taiwan – which has become very complicated due to the pandemic). We are delighted that we are able to offer this additional service to our students, and we will of course be advising, guiding and helping prepare students wishing to take the test.



Ningbo British International School
浙江宁波英伦外籍人员子女学校
Tel: 86 574 87611005
Email: nbis.admin@nbis.net.cn
Website: www.nbis.net.cn
Address: No.365 Guanghua Road, Hi-Tech Zone, Ningbo

